

NRSE Series
SMD Shielded Tiny Power Inductor
Size 8065

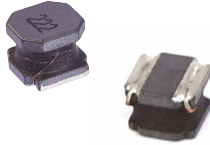

CHARACTERISTICS

- Magnetic resin for higher current and semi-magnetically shielded
- Quantity: 700pcs

APPLICATION

- DC/DC converter
- LC filter

Dimensions: [mm]

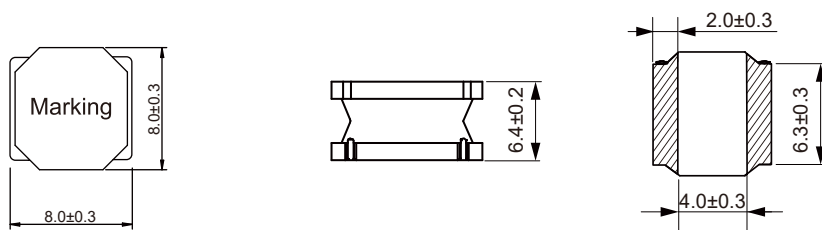

Land Pattern: [mm]

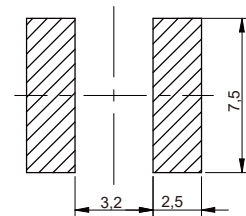

Electrical Properties:

Part No	Inductance @100KHz/0.25V (μH)	Tolerance	Saturation current (A)	Temperature Rise Current (A)	DC Resistance ±30% (Ω)
NRSE8065-4R7N	4.70	±30%	8.50	4.70	0.018
NRSE8065-6R8M	6.80	±20%	7.60	4.30	0.026
NRSE8065-100M	10.0	±20%	6.60	4.00	0.033
NRSE8065-220M	22.0	±20%	4.30	2.80	0.054
NRSE8065-330M	33.0	±20%	3.60	2.00	0.083
NRSE8065-470M	47.0	±20%	2.85	1.80	0.135
NRSE8065-680M	68.0	±20%	2.50	1.50	0.181
NRSE8065-820M	82.0	±20%	2.30	1.40	0.215
NRSE8065-101M	100	±20%	2.00	1.30	0.250
NRSE8065-151M	150	±20%	1.60	1.00	0.360
NRSE8065-221M	220	±20%	1.30	0.90	0.528
NRSE8065-471M	470	±20%	1.00	0.55	1.300
NRSE8065-102M	1000	±20%	0.65	0.40	2.350
NRSE8065-222M	2200	±20%	0.45	0.27	5.000

Operating temperature : -40 °C ~ +125 °C

Temperature rise current: the actual value of DC current when the temperature rise is ΔT40 °C

Saturation Current that will cause initial inductance to drop approximately 30%